

Specifications

Capacity – dry weight, cotton up to	60 kg
Batch diameter (nominal)	940mm
Cycle time min.	120 sec.
Moisture retention (DIN 11901) as per operation conditions	36 – 38%
Electric connected load	19.7 kW
Consumption approx.	14.8 kWh
Cooling water, utilized in the batch washer	approx. 580 l/h
Compressed air:	6 bar
Suction capacity approx.	2l/shift
Entrance dimensions, machine laid flat, hydraulics not disconnected (without oil)	W=2000mm, H=2400mm
Operational dimensions	length 2360mm, width 1960mm, height 4185 mm
Operational weight	approx. 13250 kg
Transport weight	gross 13350 kg

Application

The **Lavapress LP 582** is a single stage press for cyclic extraction of processed laundry batches consisting of 0-70 kg dry weight, transferred from the batch washer.

Extraction

Effected even and conservative by means of controlled pressure build - up via a pressure pad mounted to the press stamp containing a constant water filling.

Standard version

Solid steel design by means of a closed unit consisting of a base section, columns and head section.
Oil hydraulic with oil cooling and 300 liter filling
Pressure set up to 60 bar
Proportional pressure control
1 replacement pressure pad
In line, respective angle positioning optional
Chute for **Lavatec** batch washer
Electric supply: 3/N~50Hz, 400/300V
Micro processor control with function monitoring and manual control.
Laundry contact only with stainless steel parts.
Machine panelling made of stainless steel, wire-brushed-finish.
Large maintenance doors on two sides of machine.
Large dimensioned water collection-tank with pump device and drain connection.
Transport conveyor with drainage plate for safe batch transport from the press.
Pedestal for height adjustment.
Cooling water valve.
Machine equipped in accordance with relevant safety standards.

Special version

Chutes for selected batch washers, respective special positioning.
Conveyor extension + 480mm.
Conveyor – special length compensation by intermediate conveyor.
Electric: special voltage, special frequency, CSA-, Nema/UL-regulation.
Visual alarm
Interface for operation data recording
Additional pressure pad
Water flow pump instead of emersion pump for water return into tunnel washer
Disinfection – DHSS (prepared) automatic disinfection of transport conveyor
Embedded in disinfection of tunnel washer by means of hot water
Disinfection – complete with tank, independent chemical disinfection

Accessories

Transport units for batch transfer

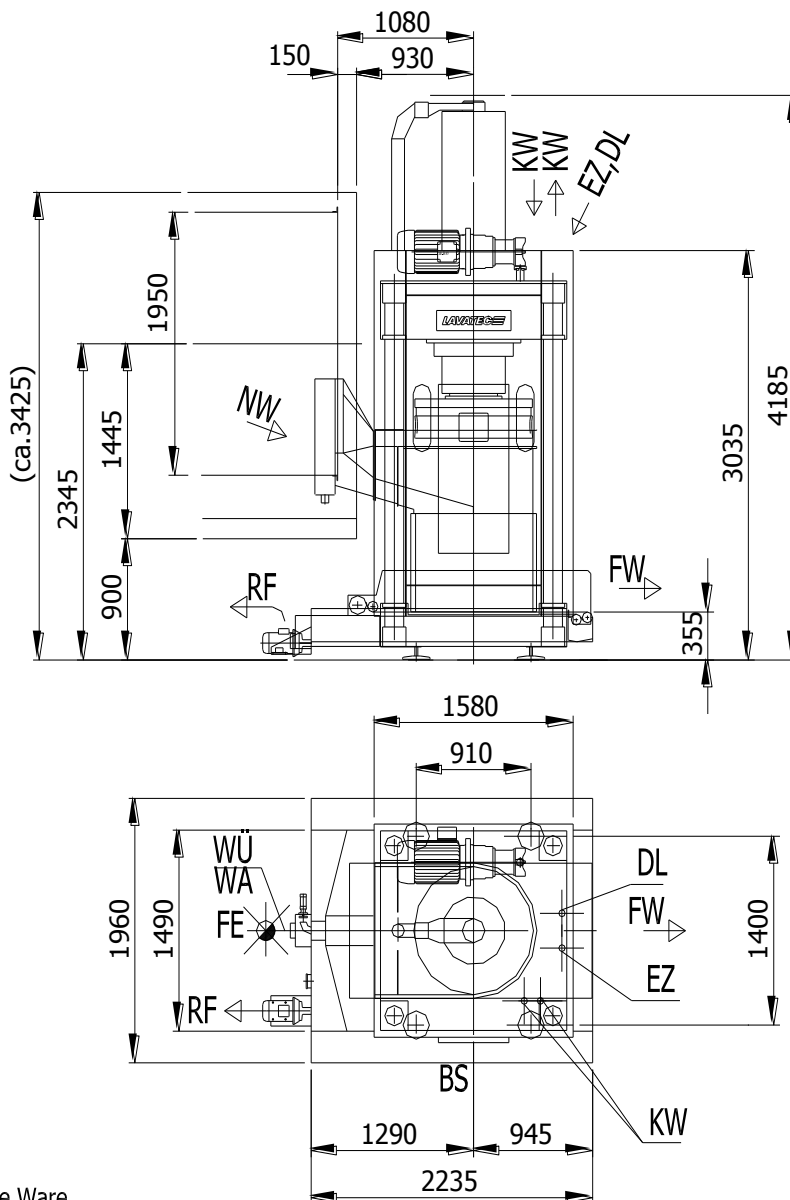

NW = nasse Ware
wet linen

Linge mouillée

FW = feuchte Ware
moist linen

Linge humide

EZ = Elektro-Zuleitung
electric supply

Arrivée électrique

RF = Rückflotte zu Waschmasch.
water recovery

DN50

DN50

DN50

DL = Druckluft
compressed air

DN 6

DN 6

Air comprimé

DN 6

WO = Wasserüberlauf
water overflow

DN100

Débordement d'eau

DN100

WA = Wasserablauf
water drainage

DN100

vidange

DN100

BS = Bedienseite
service side

Côté de commande

FE = Fußbodenentwässerung
floor drain

Drainage au sol

KW = Kühlwasser Vor-/Rücklauf

cooling water IN/OUT

Eau à refroidissement marche avant/retour

DN20 (R3/4")

DN20 (R3/4")

DN20 (R3/4")

Einbringöffnung:

Entrance dimensions:

Ouvertures d'accès:

Höhe/Height/Hauteur = ca. 2400mm

Breite/Width/Largeur = ca. 2000mm

Wandabstand = ca. 900mm

Wall distance = ca. 900mm

Distance au mur = ca. 900mm

Technische Änderungen vorbehalten/ Subject to alterations/ Modification sous Réserve